

Proposed East Elevation
1 : 200

Notes:
DO NOT SCALE FROM THIS DRAWING. USE FIGURED DIMENSIONS IN ALL CASES. VERIFY DIMENSIONS ON SITE AND REPORT ANY DISCREPANCIES TO THE ARCHITECTS IMMEDIATELY. THIS DRAWING TO BE READ IN CONJUNCTION WITH THE ARCHITECTS SPECIFICATION. © THIS DRAWING IS COPYRIGHT AND MAY ONLY BE REPRODUCED WITH THE ARCHITECTS PERMISSION.

OSi License Number - AR 005219
Projection / Spatial Reference:
Projection: IRENET196_ Irish_Transverse_Mercator
Centre Point Coordinates:
X,Y: 71367.3099,73403.2446
Reference Grid:
Map Series / Map Sheets
1:1,000 | 3263-02
1:1,000 | 3263-08
1:1,000 | 3263-07
1:1,000 | 3263-03
Vertical Datum:
MALIN HEAD

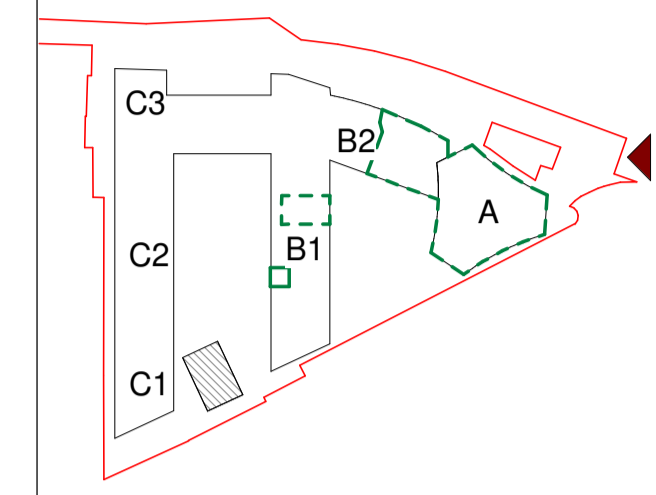

Planning Application Legend

Description	Symbol
SITING BOUNDARY LINEDARY	
EXTENT OF PROPOSED DEVELOPMENT / WORKS	
CONSENTED BUILDINGS UNDER APPLICATION REF: ABP-306569-20	

Materials Legend

No.	DESCRIPTION
1	POLISHED PRE-CAST GRANITE MIX FACADE
2	POLISHED PRE-CAST GRANITE CILL
3	POWDER-COATED ALUMINIUM WINDOW

P02	01/06/21	JB	Planning Issue
P01	02/12/20	DZ	Pre-Planning Issue

Rev	Date	DRN	Description

IN ASSOCIATION WITH
Glenn Howells Architects
Birmingham London glennhowells.co.uk
Glenn Howells Architects
321 Bedford Street
Birmingham B5 6ET
T: +44 (0)121 666 7640
W: www.glennhowells.co.uk
E: mail@glennhowells.co.uk

Client Details:
Ruirsde Developments Ltd.

Project Details:
PGATE
42A Parkgate Street, Dublin 8

Drawing Title:
Proposed East Elevation

Job No	Date	Scale@A1
P18-107D	01/06/21	1:200
Status	Drawn By:	
Planning	M.McGuire	
Purpose:	Checked By:	
Planning Permission	E.O'Brien	
Drawing Number	Revision	
PGATE-RAU-ZZ-DR-A-ELE-32003	P02	